



OAKFIELD



Bramley Avenue, Horam TN21

£1,200 Per Calendar Month



Bramley Avenue, Horam TN21

Located on Bramley Avenue in the heart of Horam, this modern two-bedroom ground floor flat offers practical living in a convenient location. Built in 2019, the property combines a contemporary layout with high-quality fixtures, designed to meet the needs of modern living.

The home features an open-plan living and dining area, creating a flexible space that's ideal for day-to-day living. The kitchen, seamlessly integrated within this area, includes modern cabinetry and all key appliances, offering both style and functionality. Two well-sized bedrooms provide comfortable sleeping quarters, and the bathroom is fitted with modern fixtures to provide a clean and neutral space.

The property is fitted with gas central heating and double-glazed windows, contributing to its excellent EPC rating of B. Outside, there is one allocated parking space for residents' use, as well as local on-street parking options.

This property offers an ideal option for those seeking a comfortable, move-in-ready home within easy reach of local amenities in Horam.

Included Appliances: Electric Hob-Oven / Washer-Dryer / Fridge-Freezer / Dishwasher

Please note:
Combined Annual Household Income Requirement: £37,500 Per Annum
Tenancy Length: 12 Months





Kitchen/Sitting/Dining Room

23'1 x 17'9 (7.04m x 5.41m)

Bedroom

11'1 x 9'2 (3.38m x 2.79m)

Bedroom

11'1 x 9'5 (3.38m x 2.87m)

Council Tax Band B: £1,876.24 Per Annum



Floor Plan

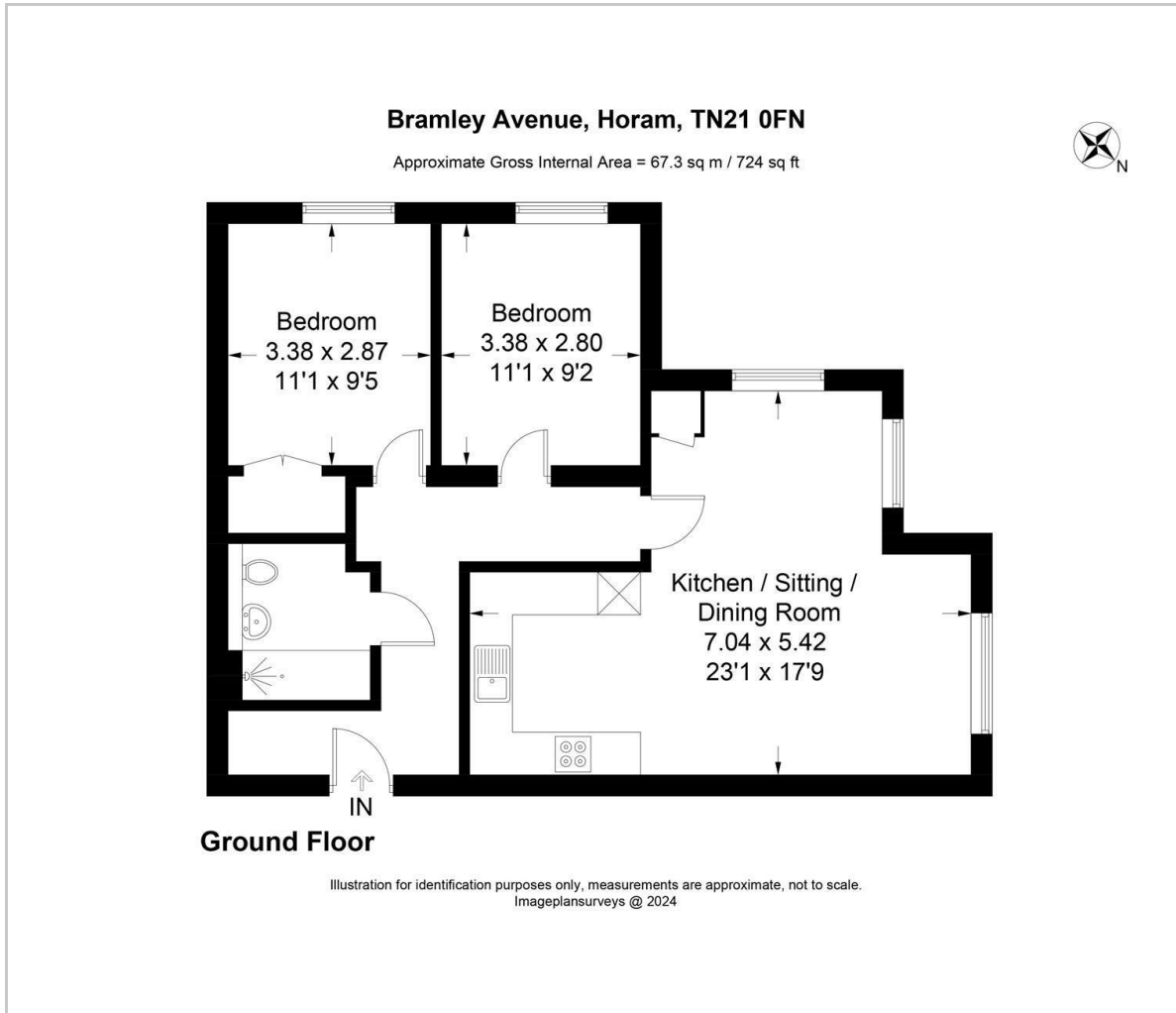

Viewing

Please contact us on 01825 729673 if you wish to arrange a viewing appointment for this property or require further information.

These particulars, whilst believed to be accurate are set out as a general outline only for guidance and do not constitute any part of an offer or contract. Intending purchasers should not rely on them as statements of representation of fact, but must satisfy themselves by inspection or otherwise as to their accuracy. No person in this firm's employment has the authority to make or give any representation or warranty in respect of the property.

Area Map



Energy Efficiency Graph

